

SNIPER-WL



Dual technology wireless sensor 868 Mhz

INSTRUCTIONS

Characteristics

- Adjustable sensitivity of detection.
- Antiflickering technology.
- Microstrip microwave with pulsed emission
- Fresnell lens 18 fasci on 4 levels.
- 90° coverage for 15 mt at a 2,1 mt installation height.
- -Wall installing with hub .
- Hub regulation 90° horiz. 30° vert.
- Absorption at rest 26 uA.
- Power supply: 3,6v- n.1 lithium battery 3v6 mod. ER14505 wired AA 2,4Ah.
- 3 years of autonomy (at standard use).
- Radio Freq. 868MHz-FM bidirectional.
- Tamper protection.
- Wireless supervision.
- Display of the battery life.
- Detection bulk (2 minutes) when the system is off, absent when the system is on.

SNIPER-WL offers the advantage of two different sensitivity levels, which allow you to chose di the best one for the place you need protection on, obtaining the best ratio between maximum capacity and minimum possibility of wrong signaling

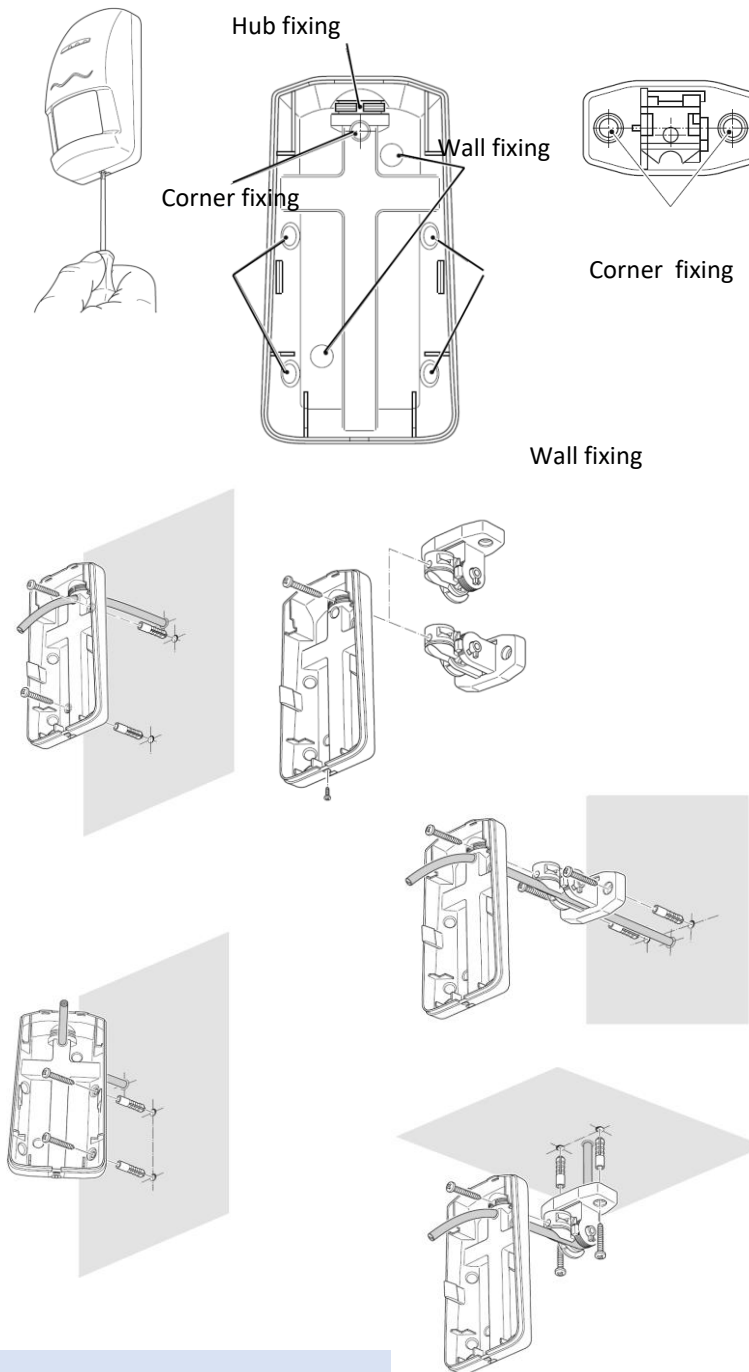

! ATTENTION: Before every trial, link the sensor to the receiver.

Cover charts

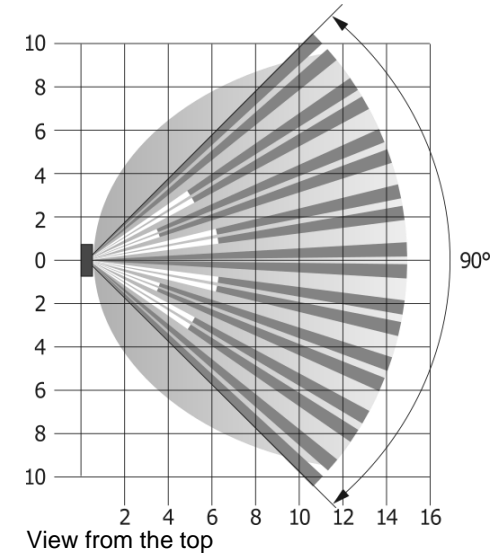

View from the top

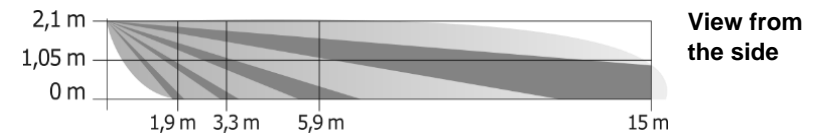

View from the side

Area di rilevazione: Infra Rosso Microonda

! ATTENTION: Before every trial, link the sensor to the receiver.

1 Installing guide

Pick the best installation point for both the technologies and, if possible, position the unit towards the inside of the area and far from doors, windows, moving objects and heat sources.

You get the best coverage by installing the detector at a 2.1 m heighmake sure the sensor has a clear view.

2.BATTERY INSERTION Remove the board and connect the battery to the circuit through the connector, positioned on the back of the board and put it in the battery carrier on the D bottom. Wait 2 minutes for the auto-calibration. The GREEN and RED LEDs will blink alternatively.

3. ACQUISITION The acquisition of the sensor in the system takes place when a Tamper alarm is generated (by releasing the Tamper button) or setting the battery in "acquisition" mode.

4RADIO COVERAGE TEST When the battery is disconnected, push the Tamper button and connect the battery. When the LED will blink, drop the Tamper button. The GREEN LED suggests a good signaling, when the GREEN and RED LEDs blink, the wireless signal is not fit, with no blinking the signal is absent. To end the Test, push the Tamper or wait for 4 minutes.

5. WALK TEST Once the lid is closed, the sensor will prepare for 3 minutes at the coverage test. Move towards the space you need protection and verify the coverage through the microwave green led and the infrared red led (the display is delayed 2 sec). The ending of the test will be signaled by the green led. If the LED is off, increase the range by turning the trimmer clockwise. Repeat the trial until you have obtained the requested status.

. N.BThe range a sto be set on the minimum required because the uW crosses the walls and a high range won't increase the performance of the system in the area.

When the RED LED blinks, it reports the infrared relevation

Premise: when functioning, at the detection of an alarm, the sensor is inhibited for 2 sec. If the SET line of the De Unire is connected, the sensor won't be inhibited, once the system is inserted.

6. ALARM MEMORY

When the system is off, the sensor will display a possible alarm through the blinking of the green and red led. The memory will be cancelled at the next insertion. It's activated in LED OFF as well.

7. BATTERY SIGNALING The low battery status is signaled through the blinking of the RED LED. In LED OFF also.

8.BATTERY REPLACEMENT To replace the battery, set the system in MAINTENANCE mode, open the sensor, remove the battery, insert a new battery and close the lid.

9. WARNING:

- explosion danger if the battery isn't replaced correctly. Replace it only with an equal or equivalent type.
- In case the battery shows leakage of liquid, change it immediately. Afterwards, clean your hands if you touched the fluid.

Warning: Because of its small dimensions, the product can be ingested easily. Keep away from children.

10. INFORMATION RELATING TO THE DISPOSAL (RAEE)



GUIDELINE)

- Warning: don't throw this product in the normal trash bin!
- The electrical and electronical equipment must be managed separately in accordance with the legislation requesting the management, the disposal and recycling of such products

DISPOSAL OF THE BATTERY:

Warning: the battery contains polluting substances, therefore it must be put in special predisposed to the collecting and disposal of polluting waste.

RED directive, rule EN 60950-1, EN 50130-4, EN 50130-5 EN61000-6-3, EN 300 440, EN301489-3 e EN 62479

DECLARATION OF CONFORMITY EU

DeTech declares that the product is in accordance with the 2014/53/UE directive. The EU declaration of conformity is available on the following site www.DeTechsrl.it



Dip1 Pos OFF LED ON
Displaying is enabled,when the GREEN LED is on, the alarm is received correctly
Dip1 Pos ON LED OFF
Disabled displaying
Dip3 Pos OFF SENS HIGH
Standard sensibility
Dip3 Pos ON SENS LOW
Low sensibilit , best for places with environmental instabilities

This product is ensured for 5 years (upon the occurrence of malfunctioning or manufacturing faults).

DATA	
Power supply	3,6V cc+/-30%
Max absorption	30 uA
Microwave	Strip 10.525GHz 8 dBm
Alarm length	3 sec.
RFI immunity	0,1/500 MHZ 3V/m
Working temperature	-5°C/+55°C
Radio frequency	Bidirectional 868 FM
Humidity	95%

CE Declaration				
AT	BE	BG	CY	HR
DK	EE	FI	FR	DE
EL	IE	IT	LV	LT
LU	MT	NL	PL	PT
GB	CZ	RO	SK	SI
ES	SE	HU		

De Tech srl

Via Enzo Benedetto 27/b 00173 Roma Italia

Tel 06/72016428 info@detechsrl.it www.detechsrl.it

